

- NOTES:
- 1) DIMENSIONS IN () ARE MILLIMETERS.
 - 2) (2) BRACKETS REQUIRED PER BOX.

GENERAL INSTRUCTIONS

END VIEW SHOWS TRUE ROTATION AND/OR LOCATION OF ALL ITEMS.
WHENEVER INDENTS, SLOTS OR SPOTWELDS ARE CALLED FOR, IT IS UNDERSTOOD THEY ARE TO BE EQUALLY SPACED.
WHEN SHOWN, BODY SEAM, TUBE JOINT, DRAIN HOLE AND SLOTS MAY BE AT RANDOM ANGULAR LOCATION UNLESS SPECIFIED.
STAMP DATE OF FABRICATION ON PRODUCT.
OPTION: .25 DIA. HANGER HOLE MAY BE LOCATED WITHIN THE SLOTTED AREA.

TOLERANCES UNLESS OTHERWISE SPECIFIED	.X TOLERANCE OF ± .1 .XX TOLERANCE OF ± .06	.XXX TOLERANCE OF ± .030 ANGULAR DIMENSIONS OF ± 2°
---------------------------------------	--	--

THIRD ANGLE
PROJECTION

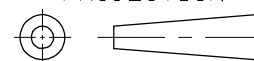

NELSON DIVISION RESERVES PROPRIETARY RIGHTS TO THIS DRAWING AND THE DATA SHOWN THEREON AND IS SUBMITTED IN CONFIDENCE ONLY. SAID DRAWING AND/OR DATA ARE NOT TO BE USED OR REPRODUCED FOR ANY PURPOSE WITHOUT THE EXPRESSED WRITTEN CONSENT OF NELSON DIVISION.

CUSTOMERS PART NO.	
MATERIAL 10 GA. MILD STEEL EXCEPT AS NOTED	
FINISH ALUMINUM PAINT	
DRAWN: GDG	DATE: 11-24-10
CHECKED: JDM	DATE: 11-24-10
DWG. NO. 80-3987	REV. 0